

J.BURROWS

• • • • •

ASSEMBLY INSTRUCTION

JBMERGECWS

MERGE CNR WORKSTATION (3CTNS)

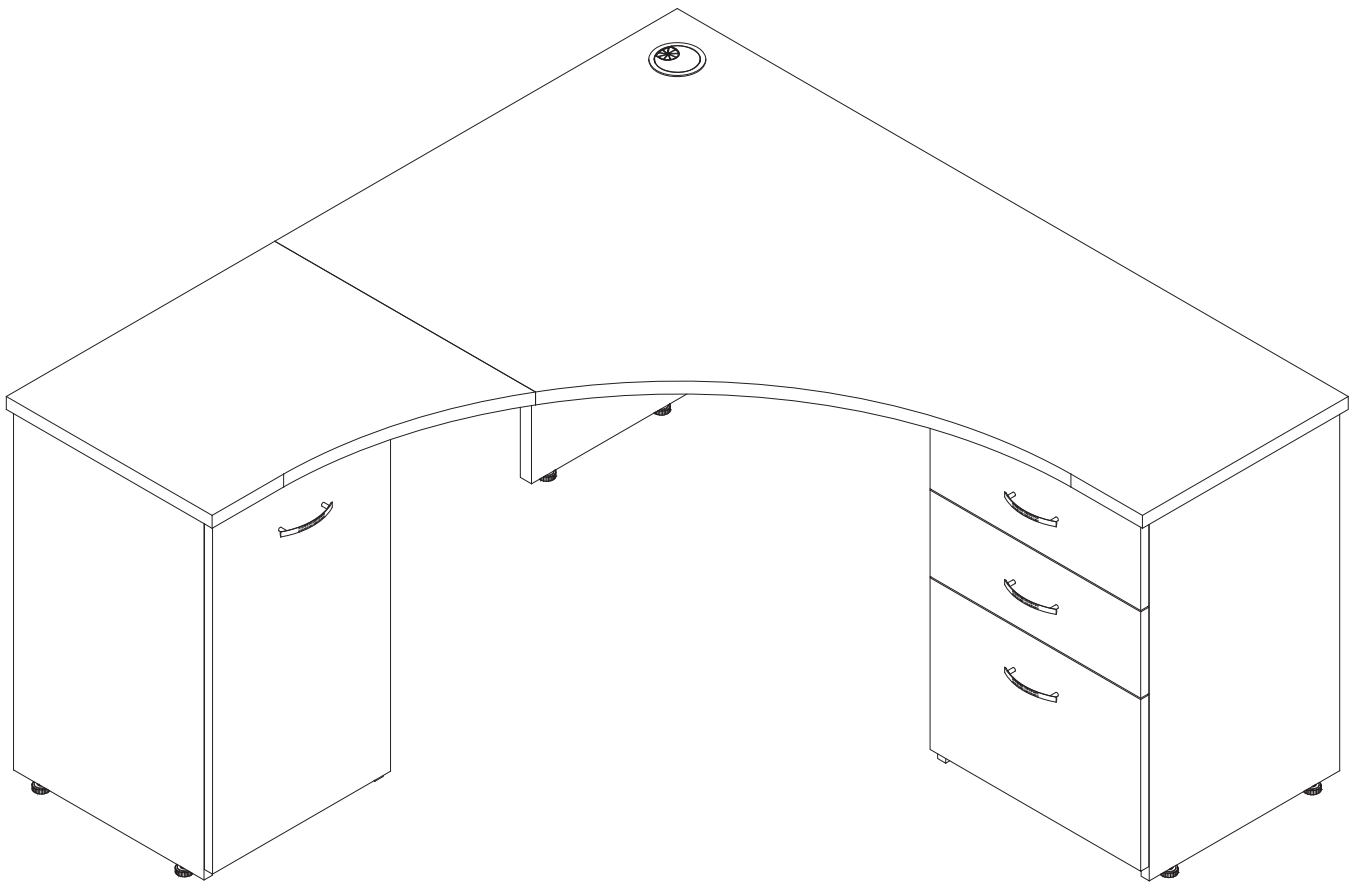

Important

Estimated Assemble Time: 70min



MORE THAN 1 PERSON
IS REQUIRED TO SAFELY
ASSEMBLE THE ITEM



HOTLINE



ASSEMBLE ON A CLEAN,
FLAT SURFACE

Tools Required For Assembly

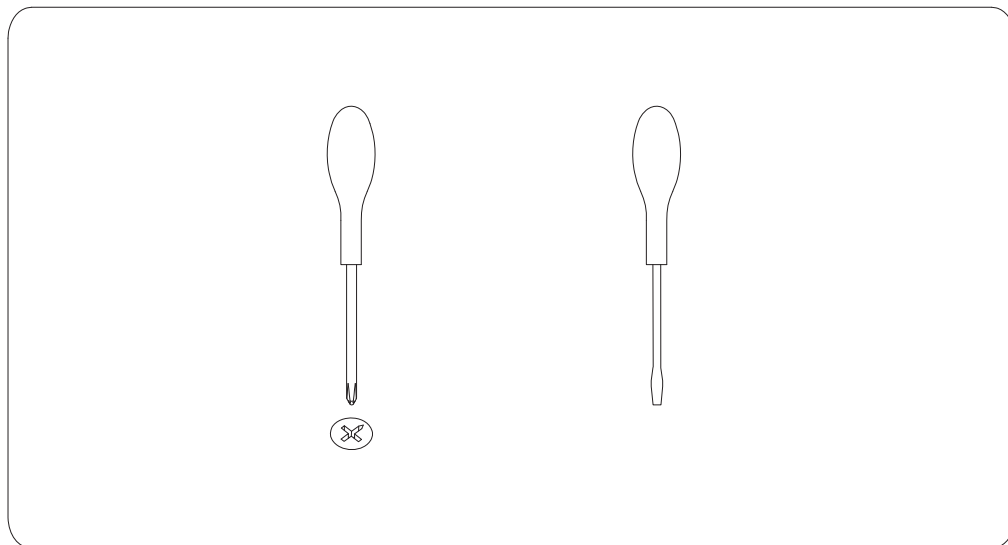

Please check you have all hardware components before assembling.

If you are missing any hardware components from the Hardware List please contact My Zone on Tel: (03) 9310 3011, or Email: hardware@myzone.net.au

Please ensure you have the name of the item, store purchased from, hardware part required and quantity. If you are missing any panels from the Panel List please contact your store of purchase.

Please retain your receipt to validate warranty. Enjoy your new purchase!

Panel List

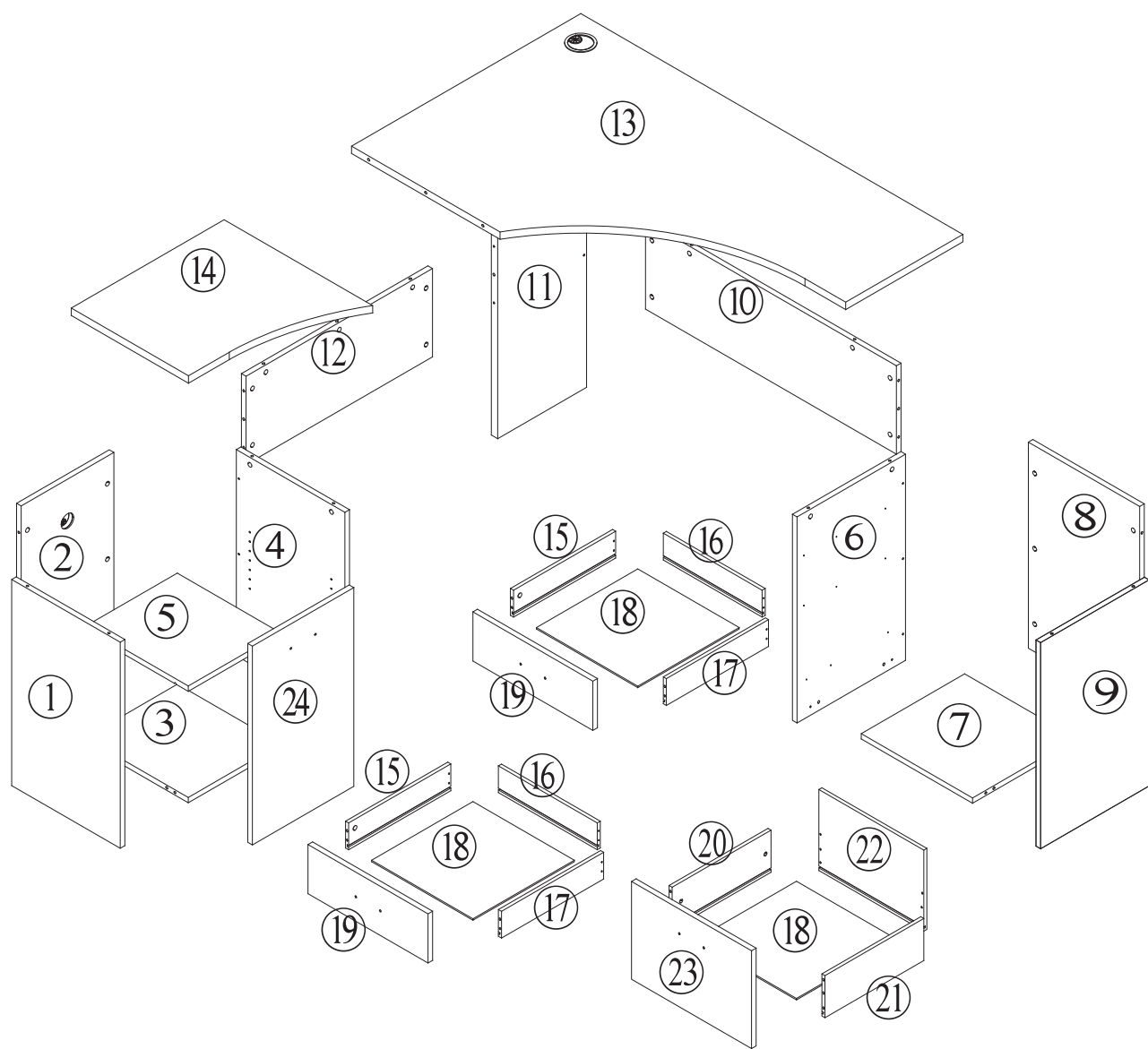

Hardware List

A

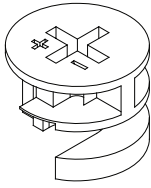

Ø15 X 12mm
41 pcs

B

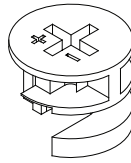

Ø12 X 10mm
8 pcs

C

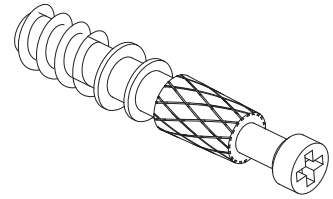

Ø6 X 35mm
41 pcs

D

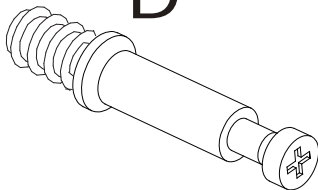

Ø6 X 35mm
8 pcs

E

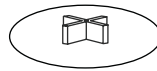

Cam Lock Cap
13 pcs

F



Ø7.8 X 30mm
15 pcs

G



Ø5.8 X 30mm
12 pcs

H

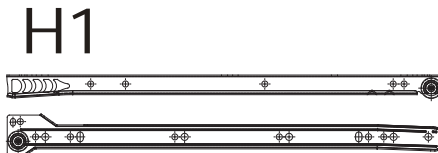

H1

H2

2 sets

I

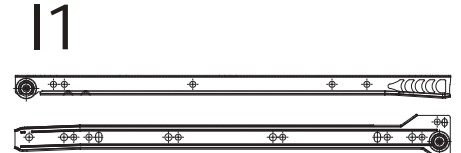

I1

I2

2 sets

J



2 sets

K

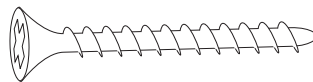

Ø4 X 30mm
8 pcs

L

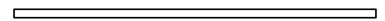

Filing Rail
2 pcs

M

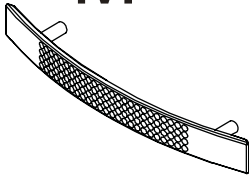

Handle
4 pcs

N

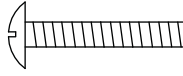

Ø3 X 25mm
8 pcs

O

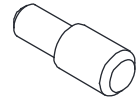

Shelf Support
4 pcs

P

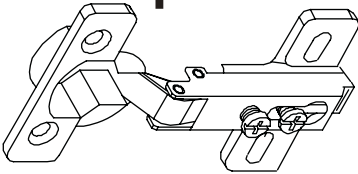

Hinge
2 pcs

Q



Ø3.5 X 16mm
8 pcs

R

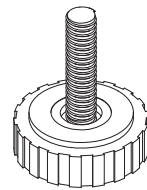

Adjust Feet
10 pcs

S

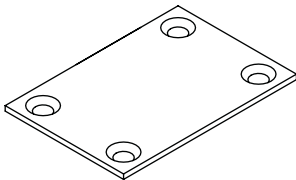

1 pc

T

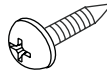

Ø3 X 10mm
4 pcs

U

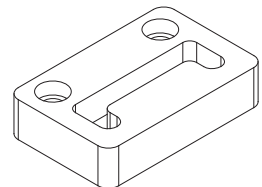

4 pcs

V

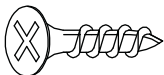

Ø3.5 X 18mm
8 pcs

W

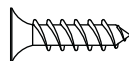

Ø3.5 X 12mm
36 pcs

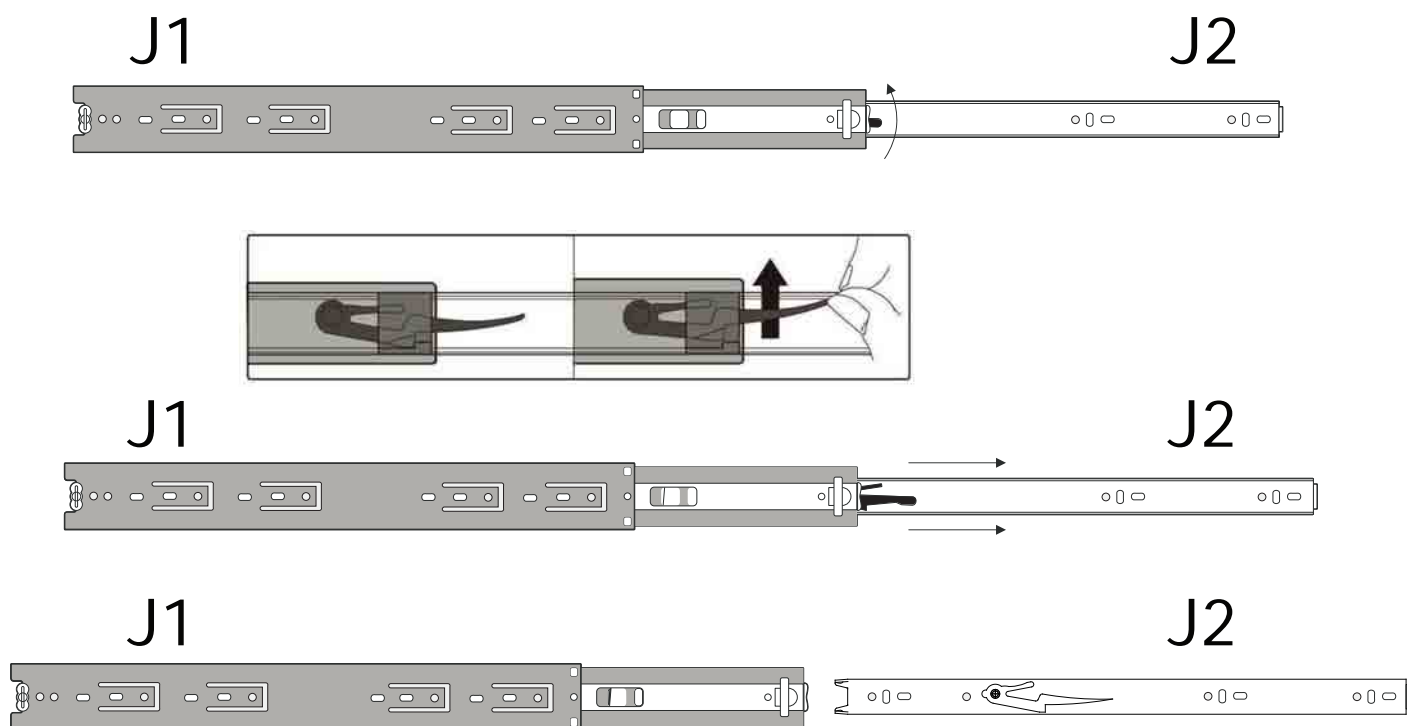

Remark:

Press the plastic slider in the indicated direction to separate drawer runner J1 and J2 before assembling

Step 1

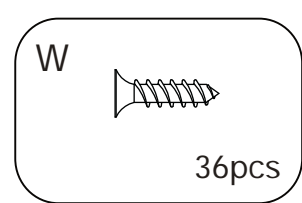
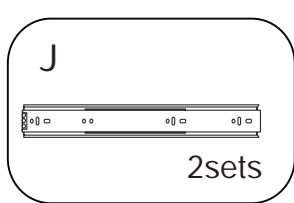
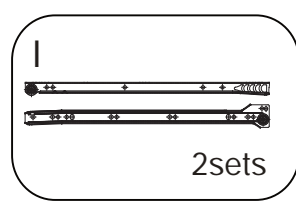
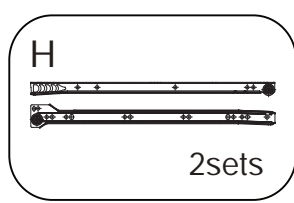
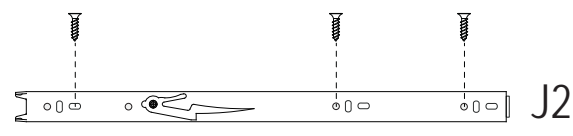
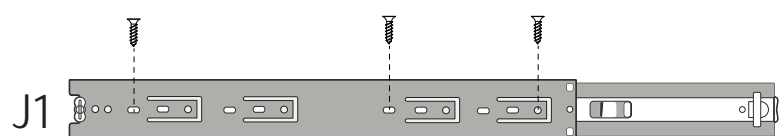
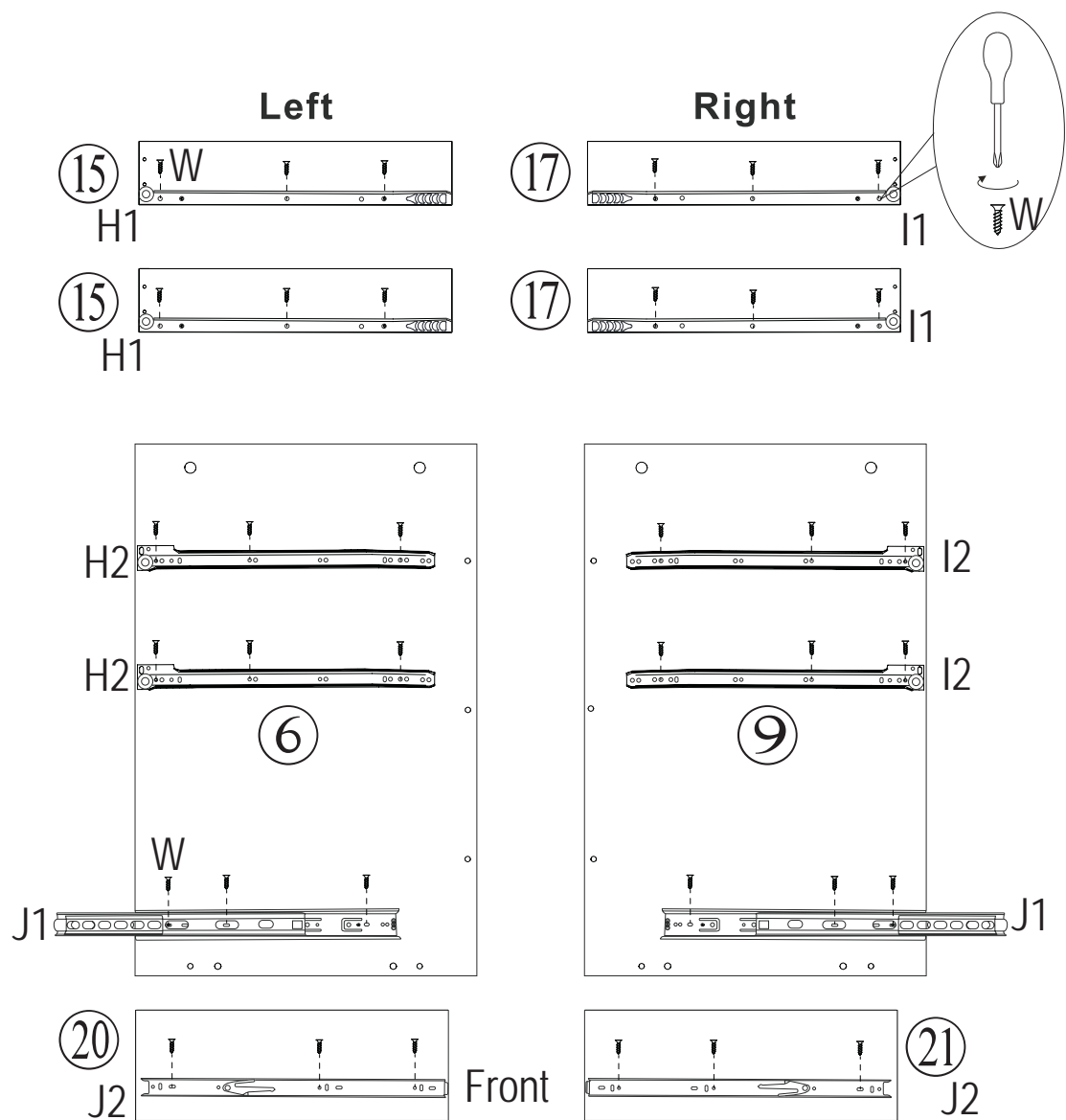

Step 2

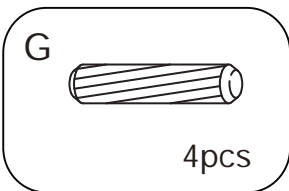
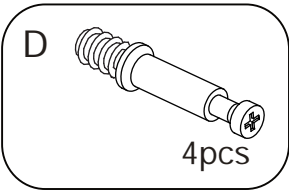
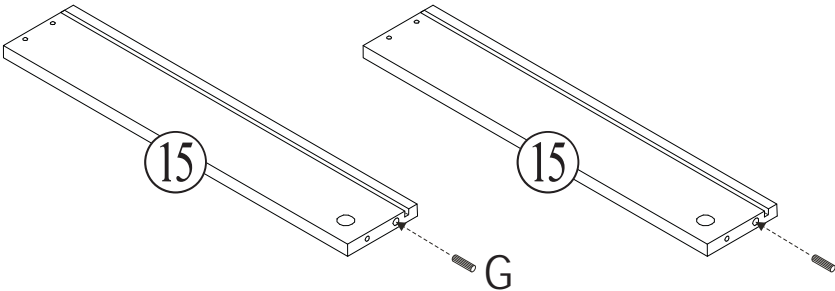
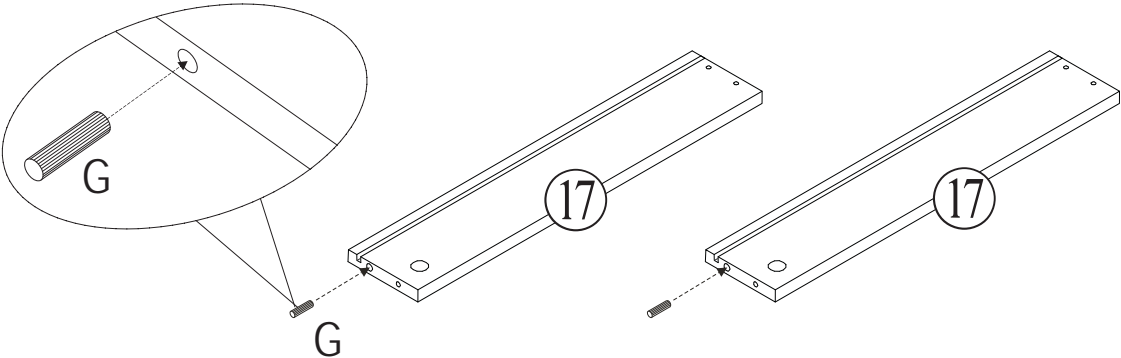
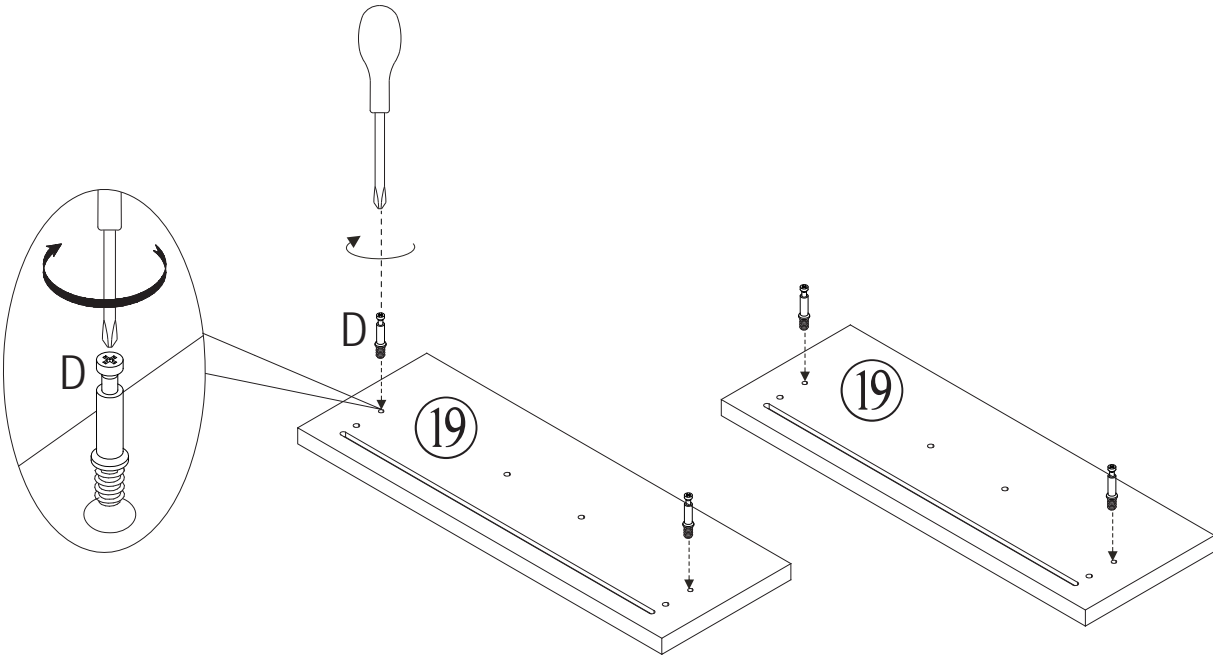

Step 3

2X

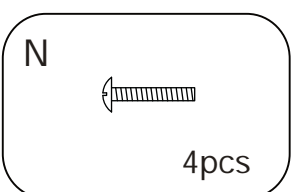
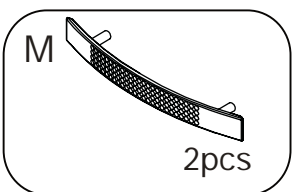
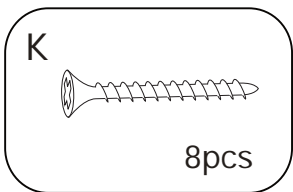
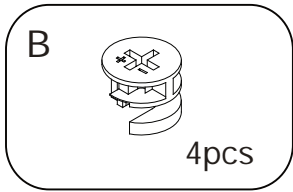
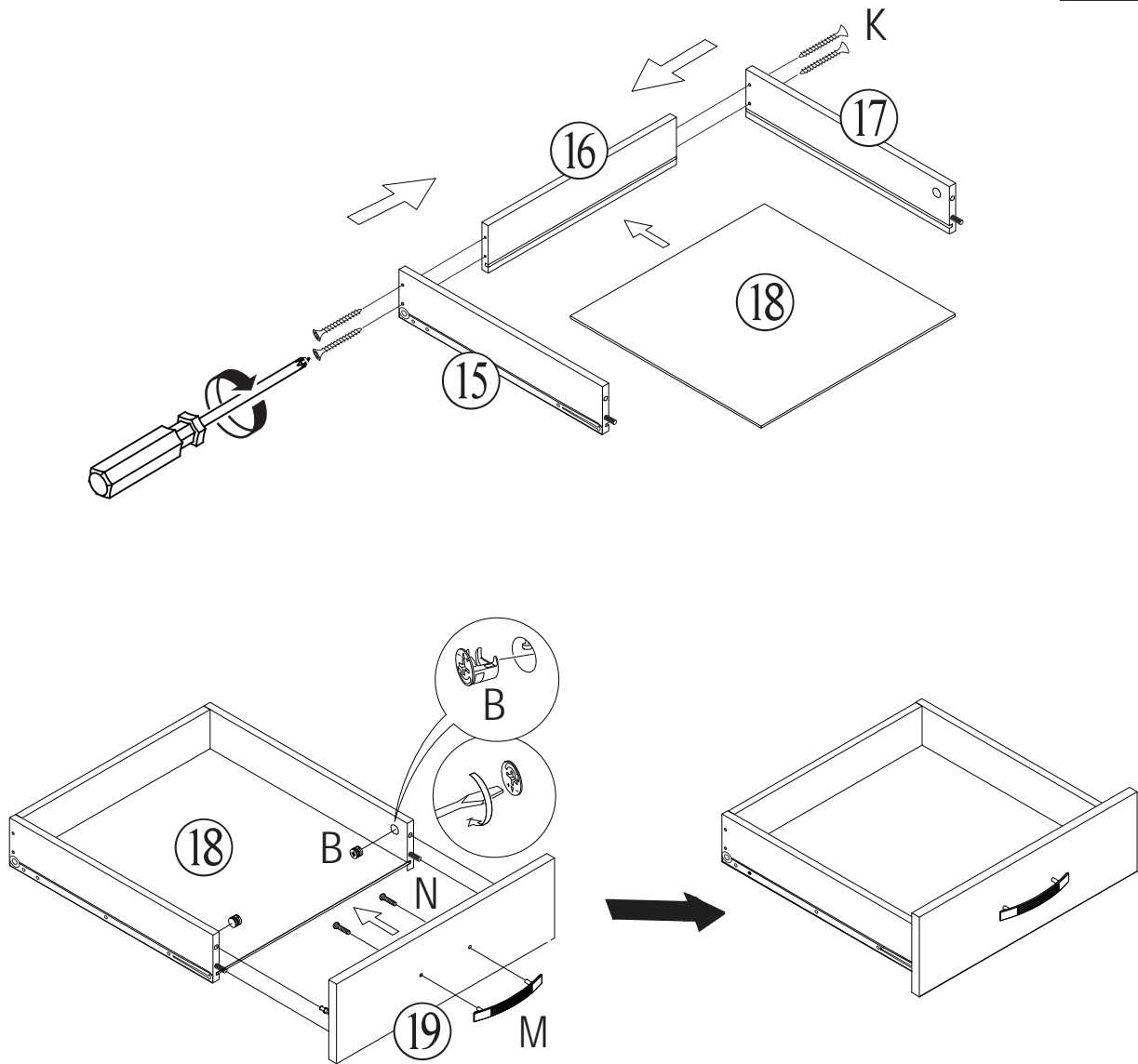

Step 4

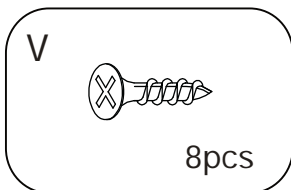
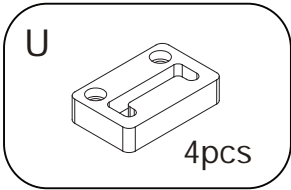
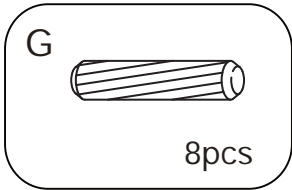
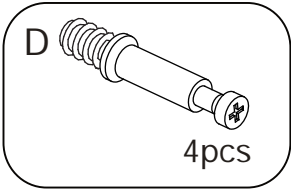
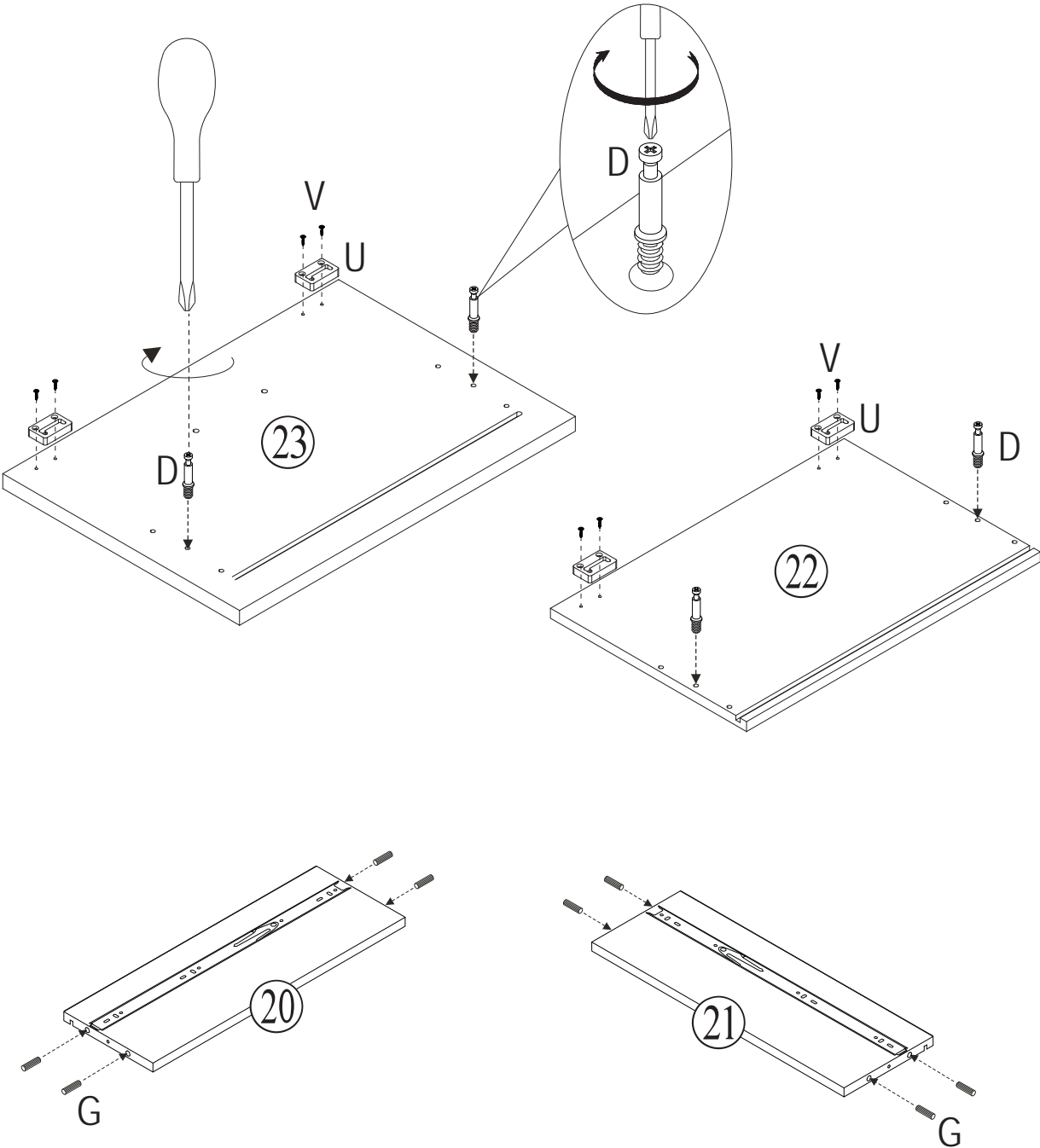

Step 5

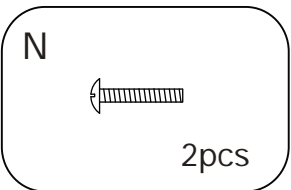
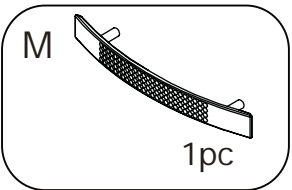
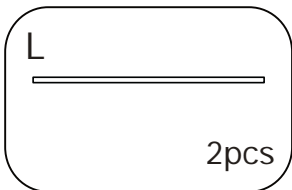
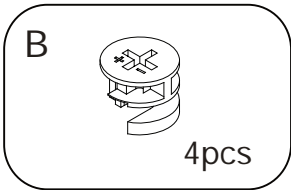
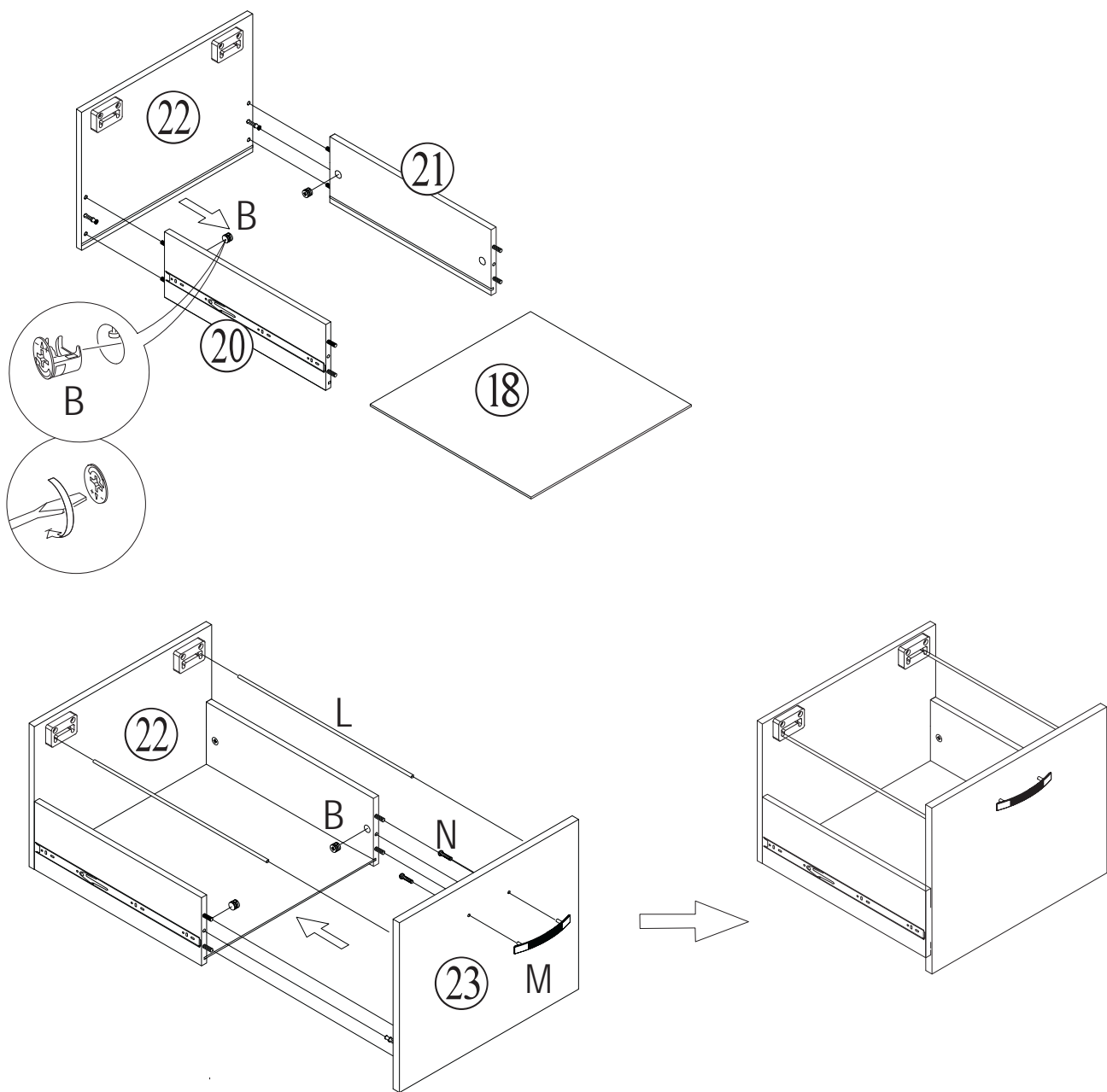

Step 6

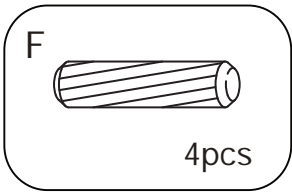
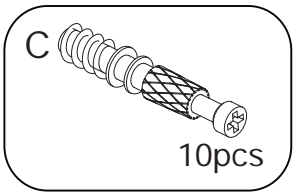
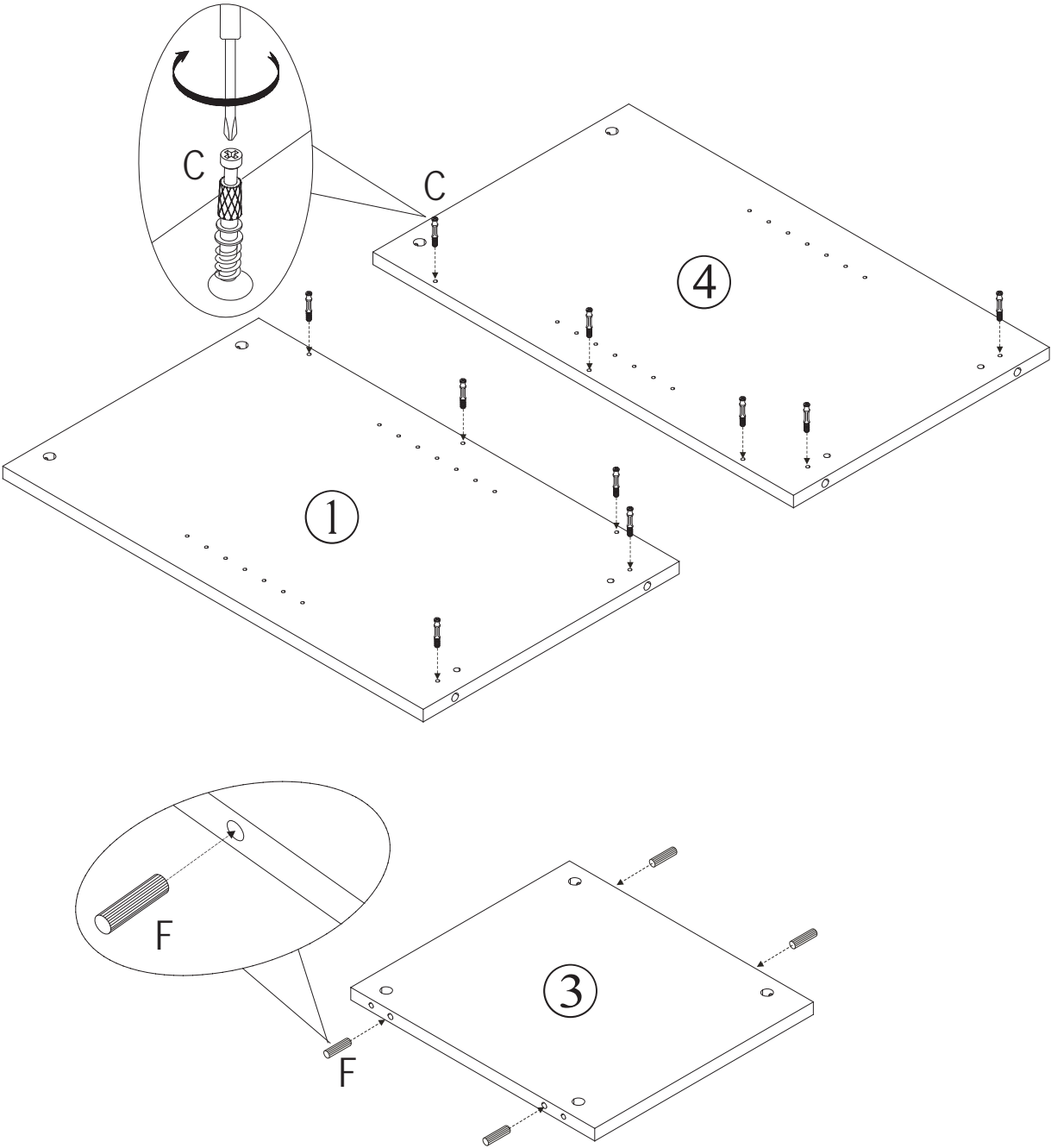

Step 7

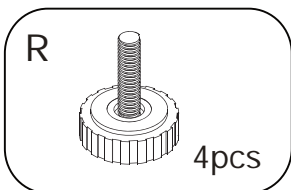
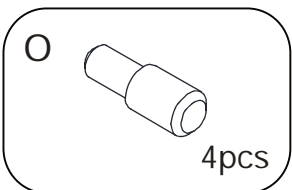
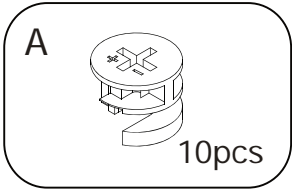
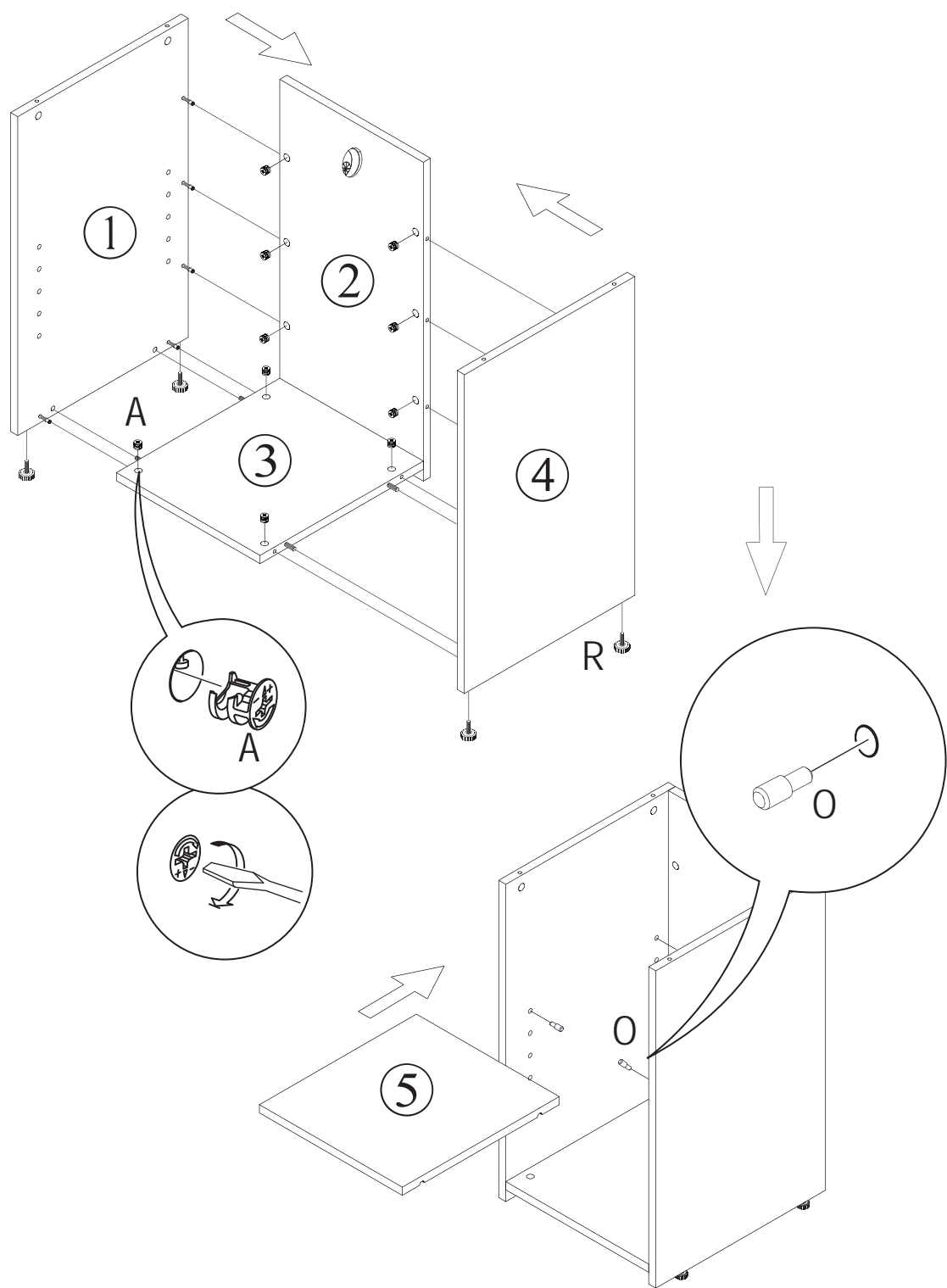

Step 8

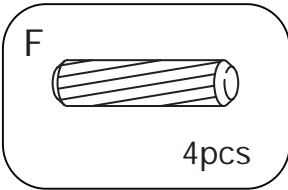
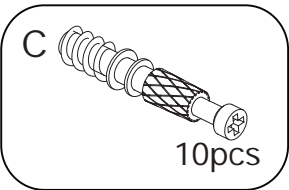
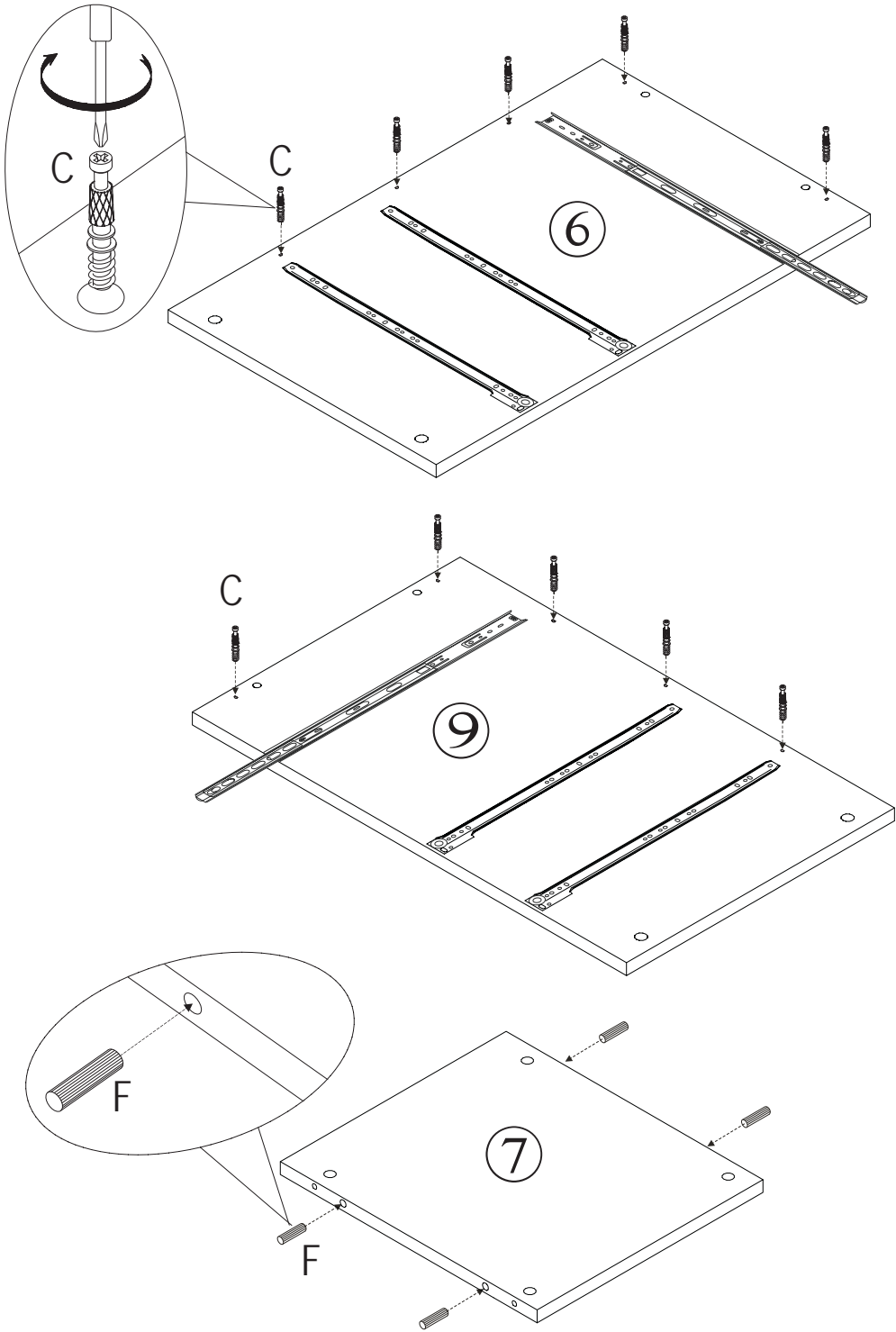

Step 9

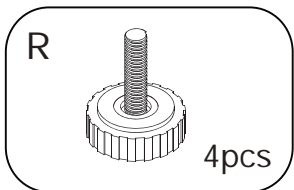
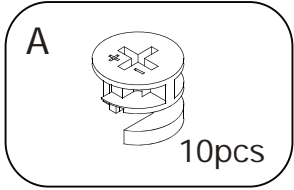
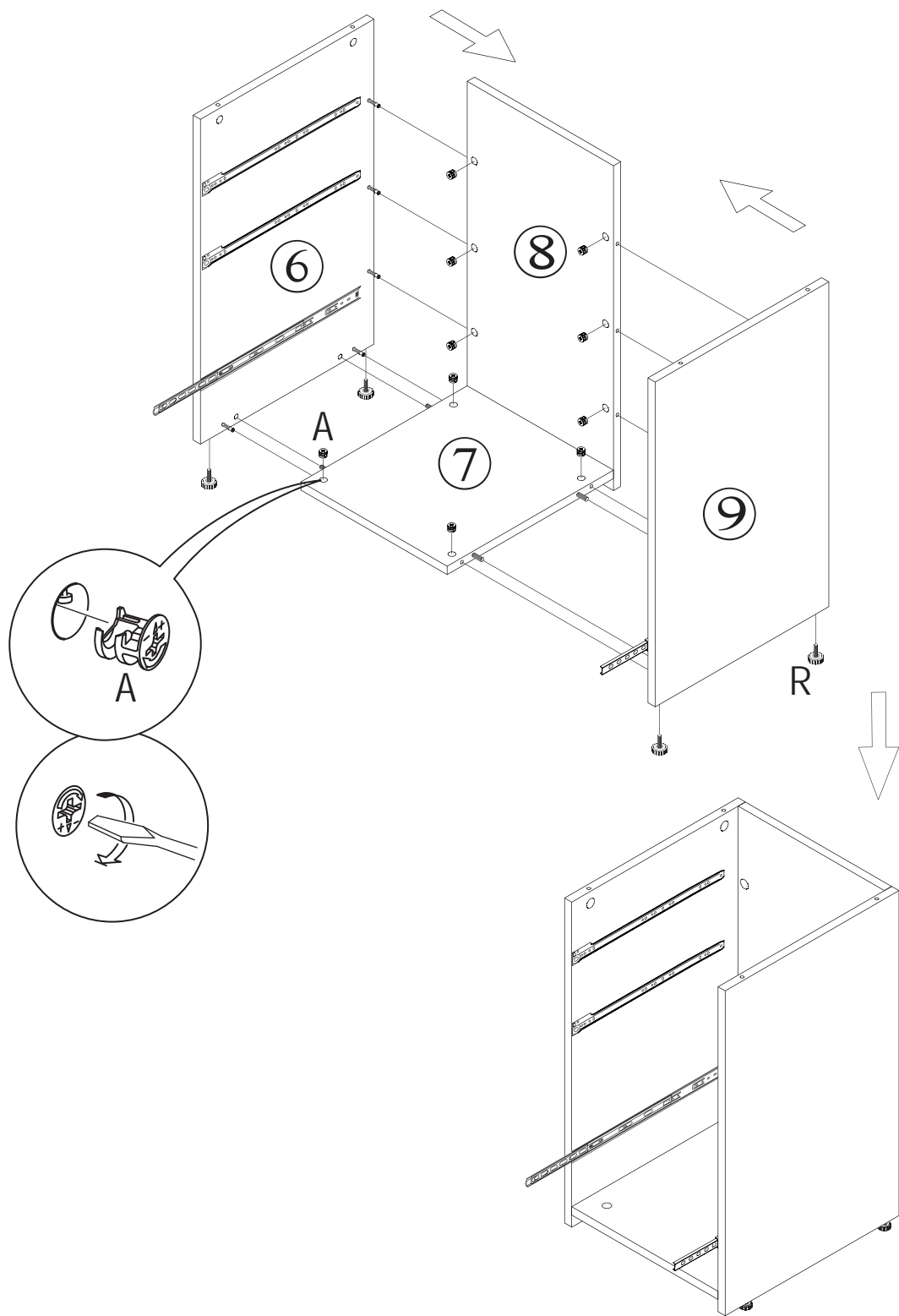

Step 10

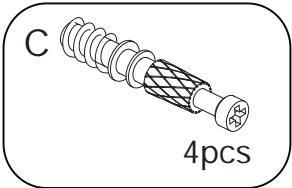
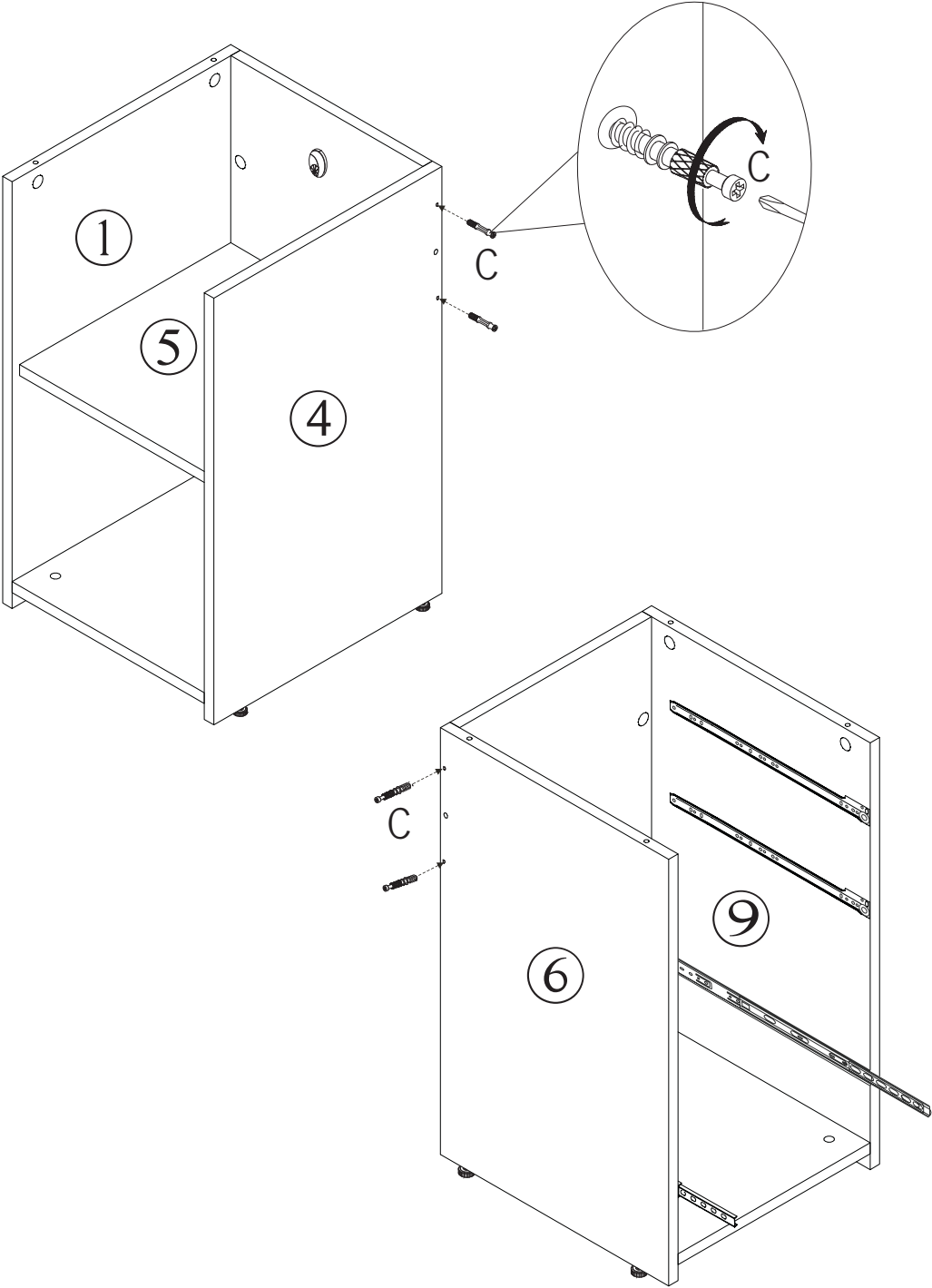

Step 11

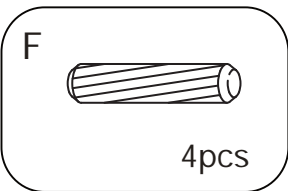
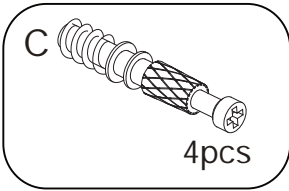
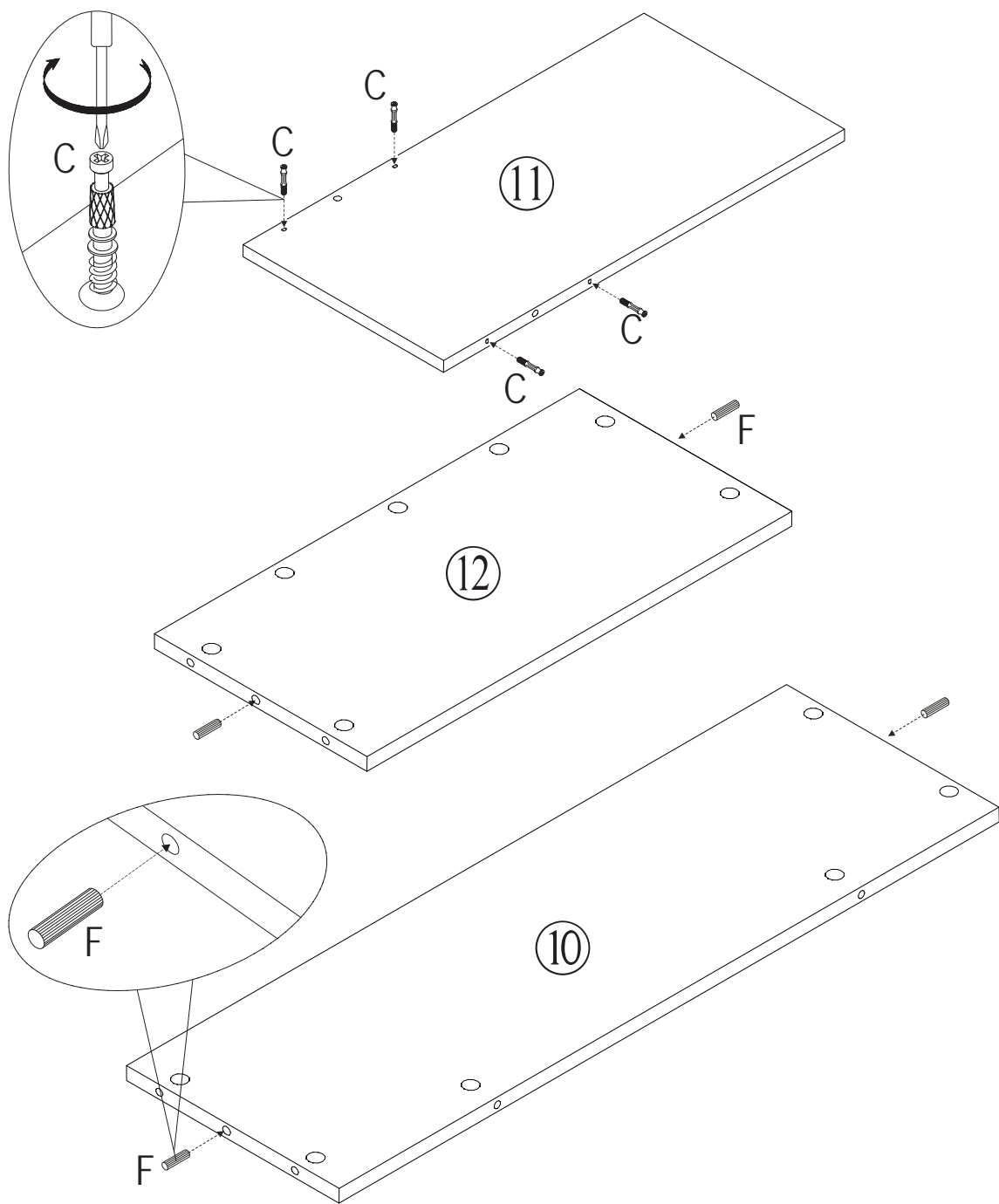

Step 12

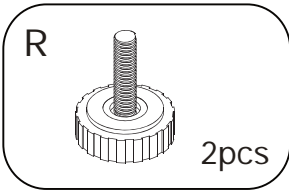
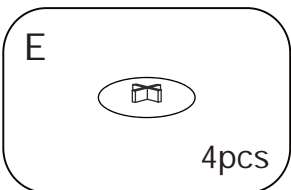
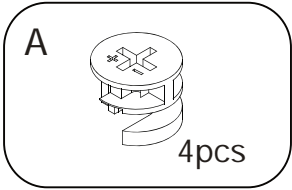
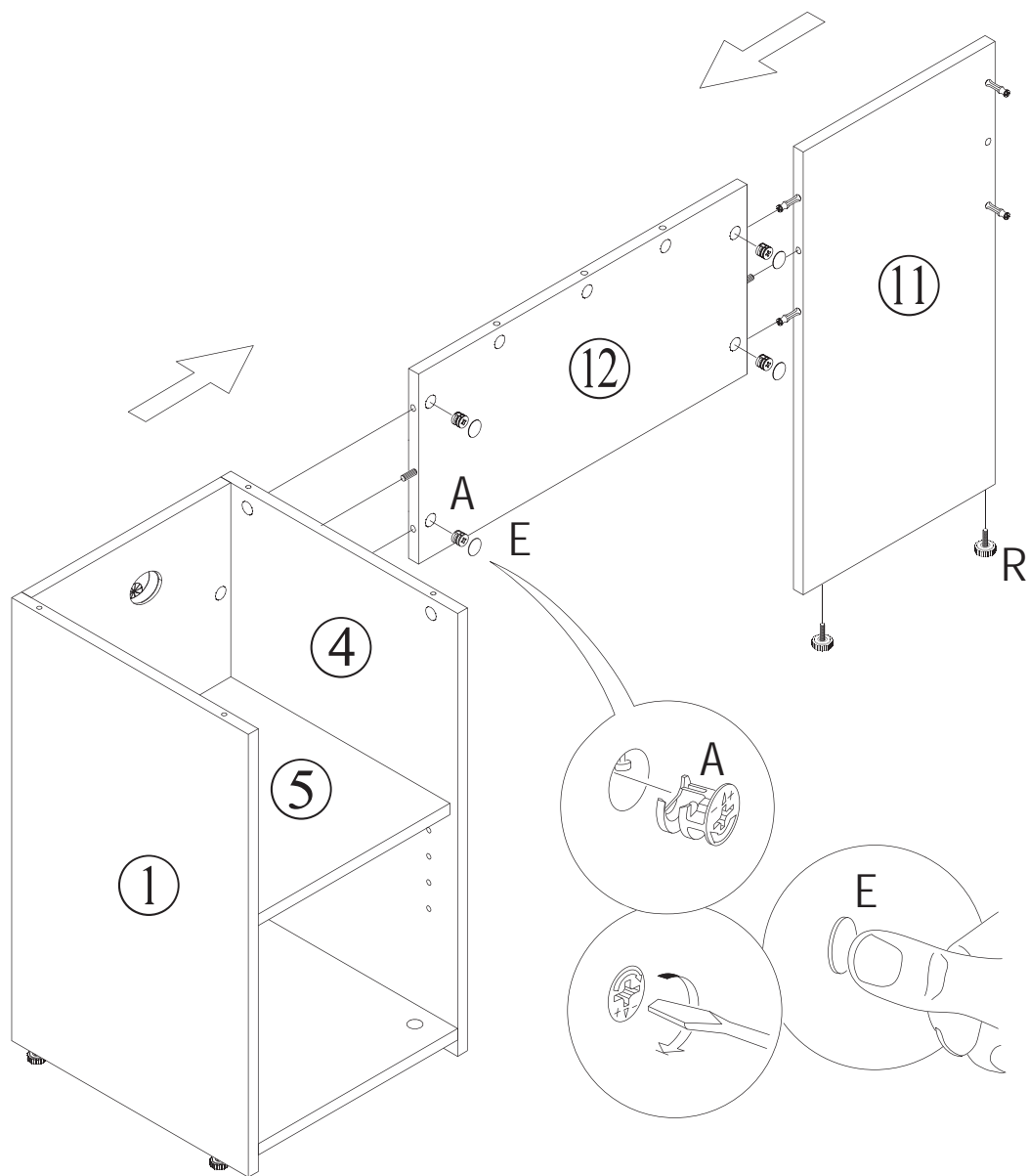

Step 13

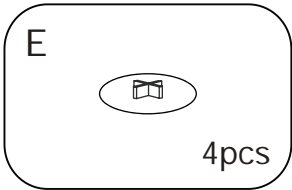
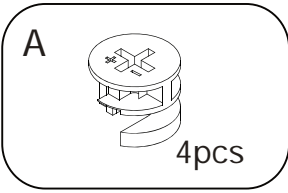
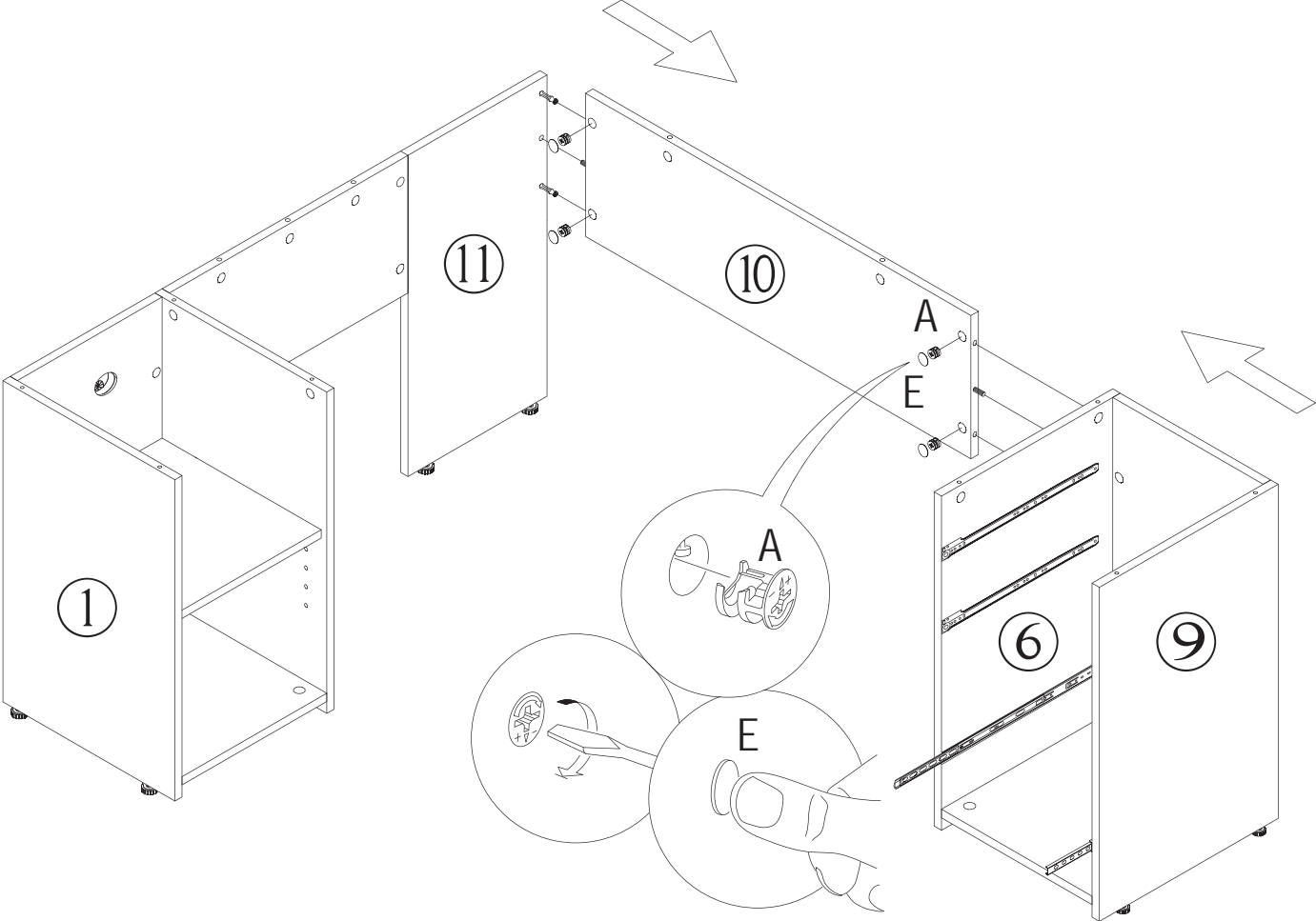

Step 14

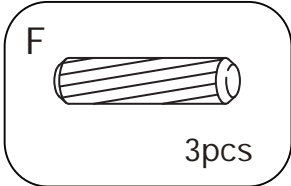
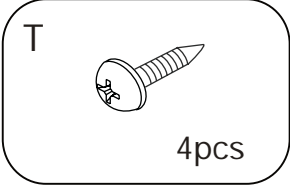
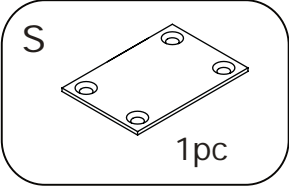
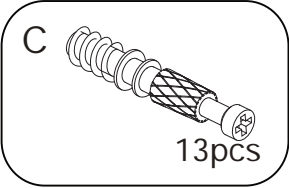
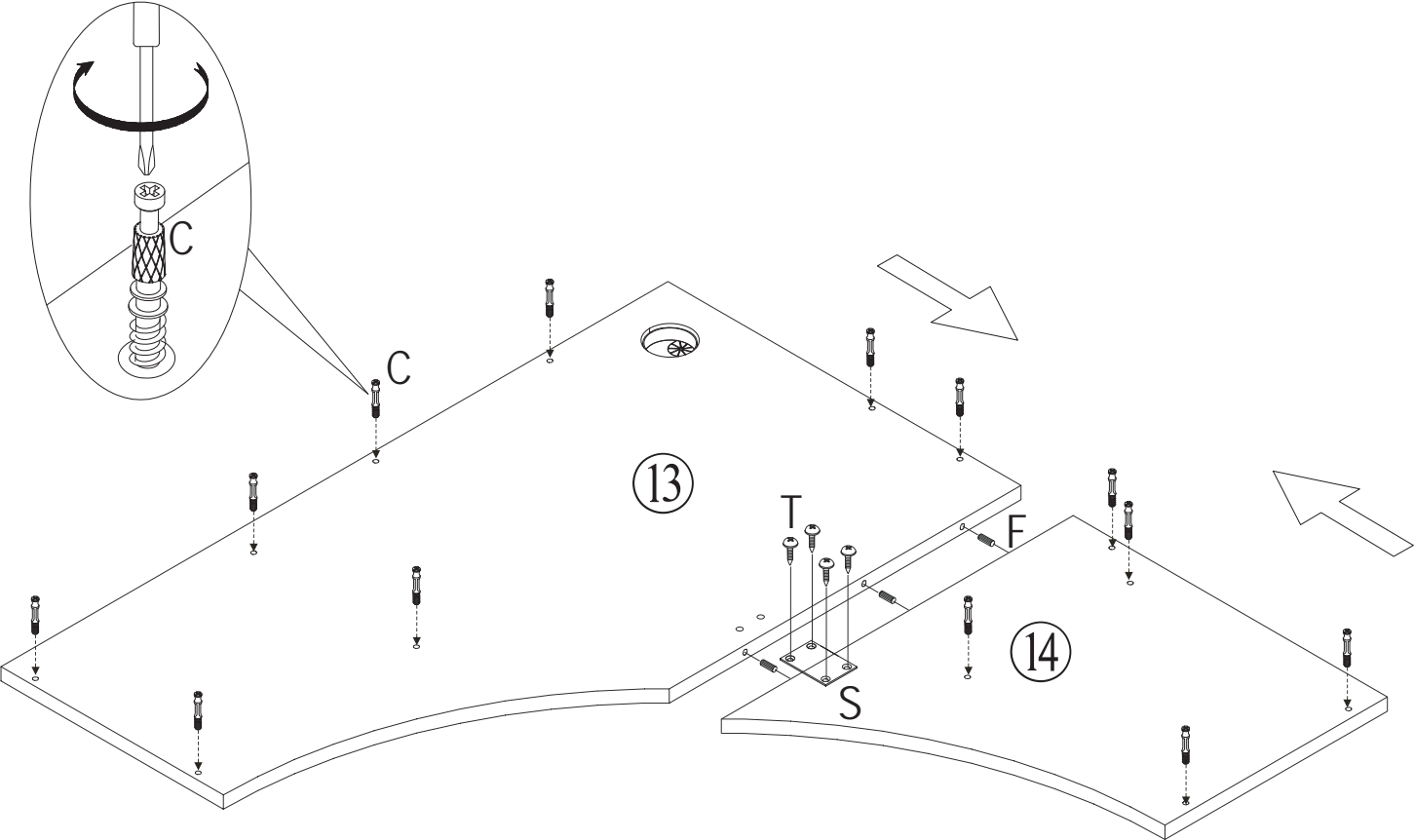

Step 15

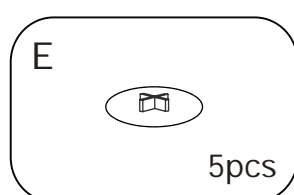
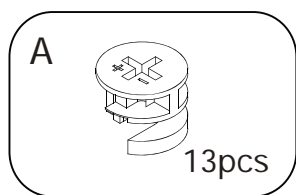
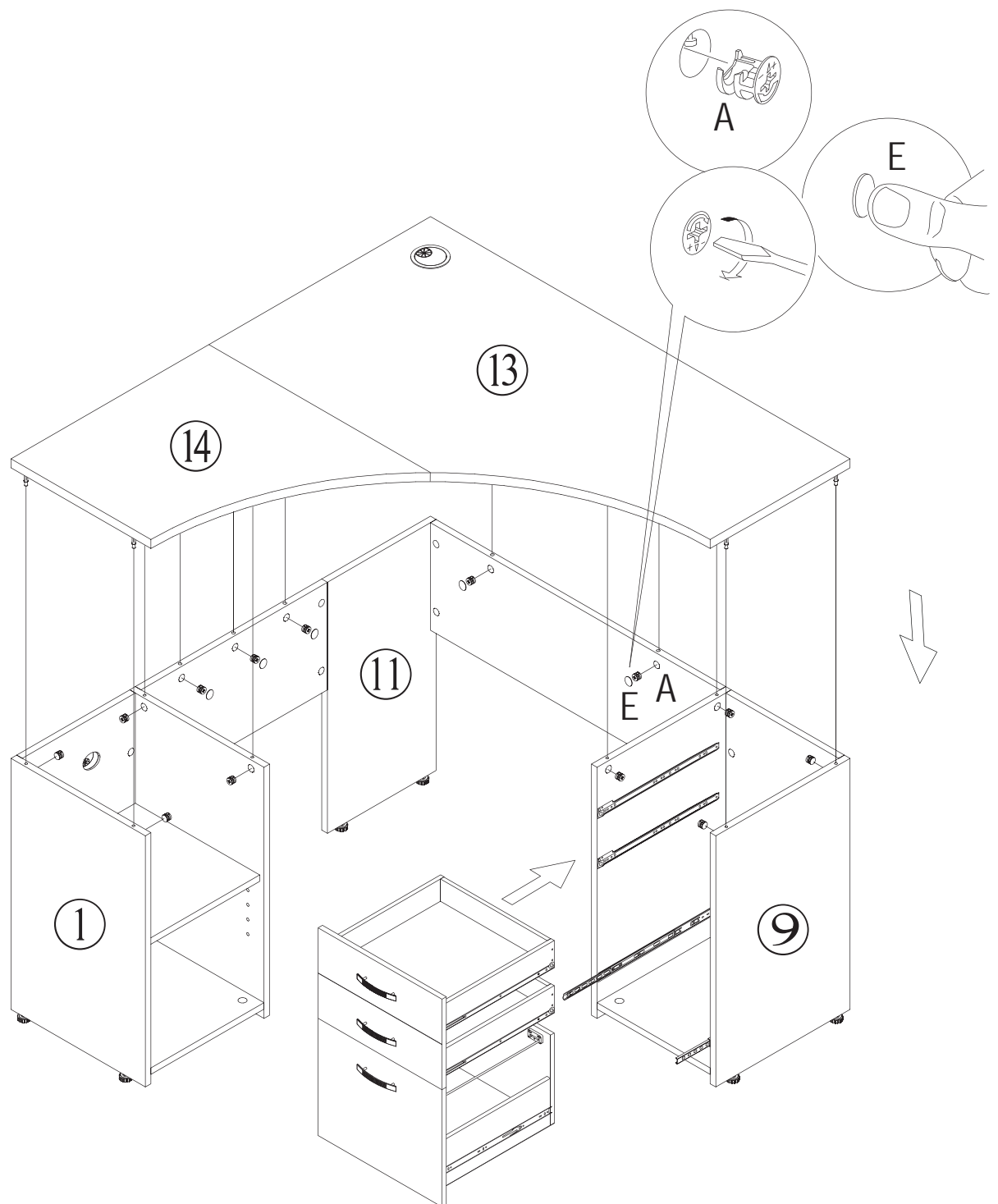

Step 16

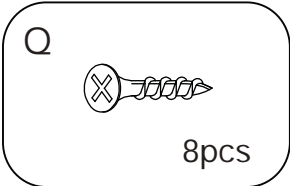
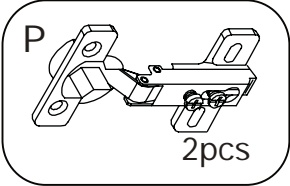
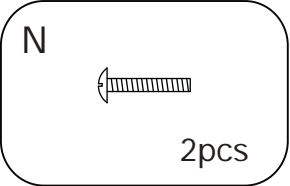
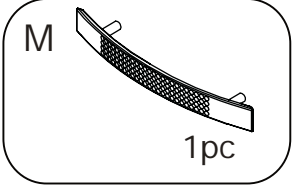
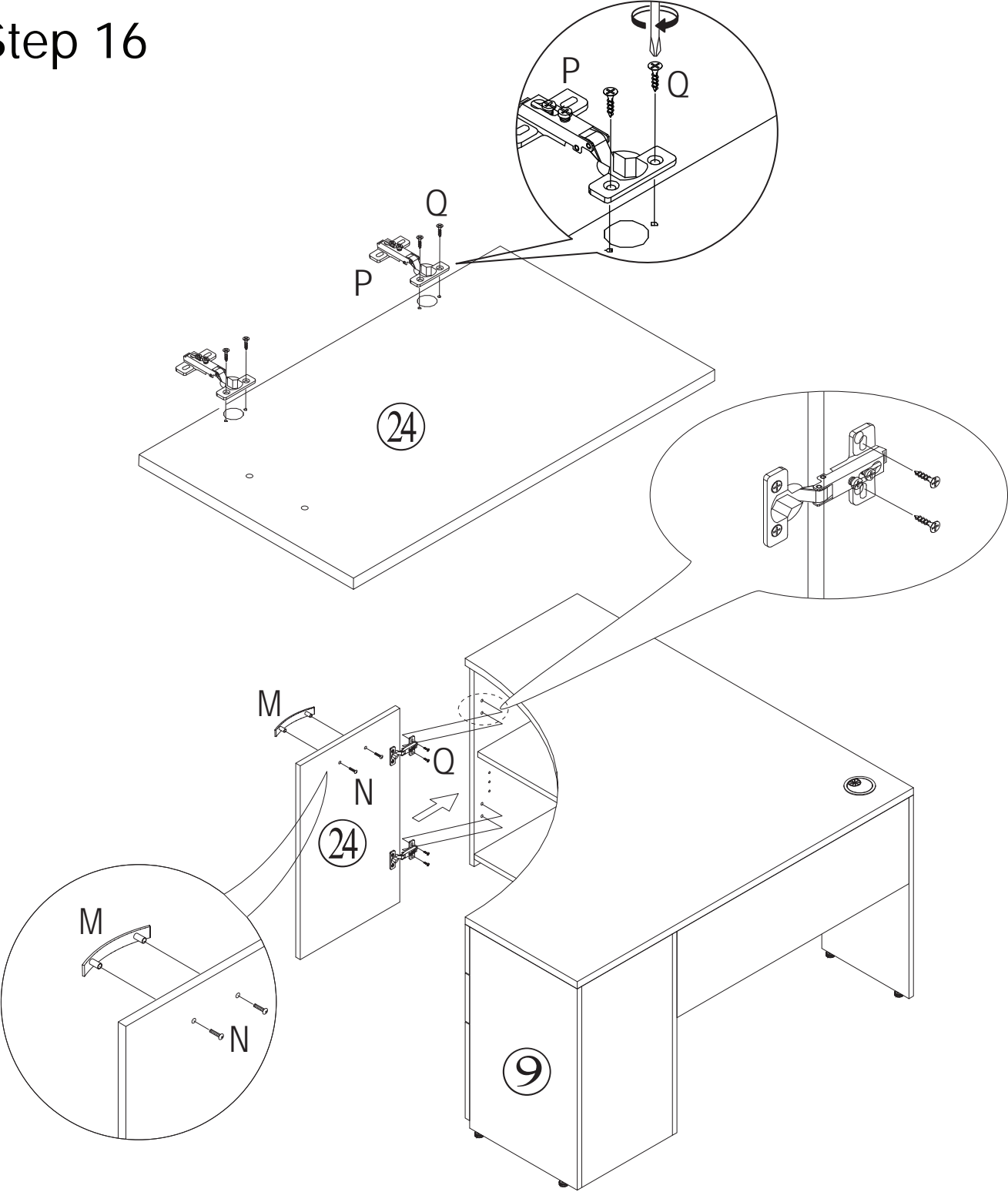

Step 17

Maximum Load Capacity:

Desk Top-55kg

Stationery Drawer-5kg

Filing Drawer-12kg

Shelf-10kg

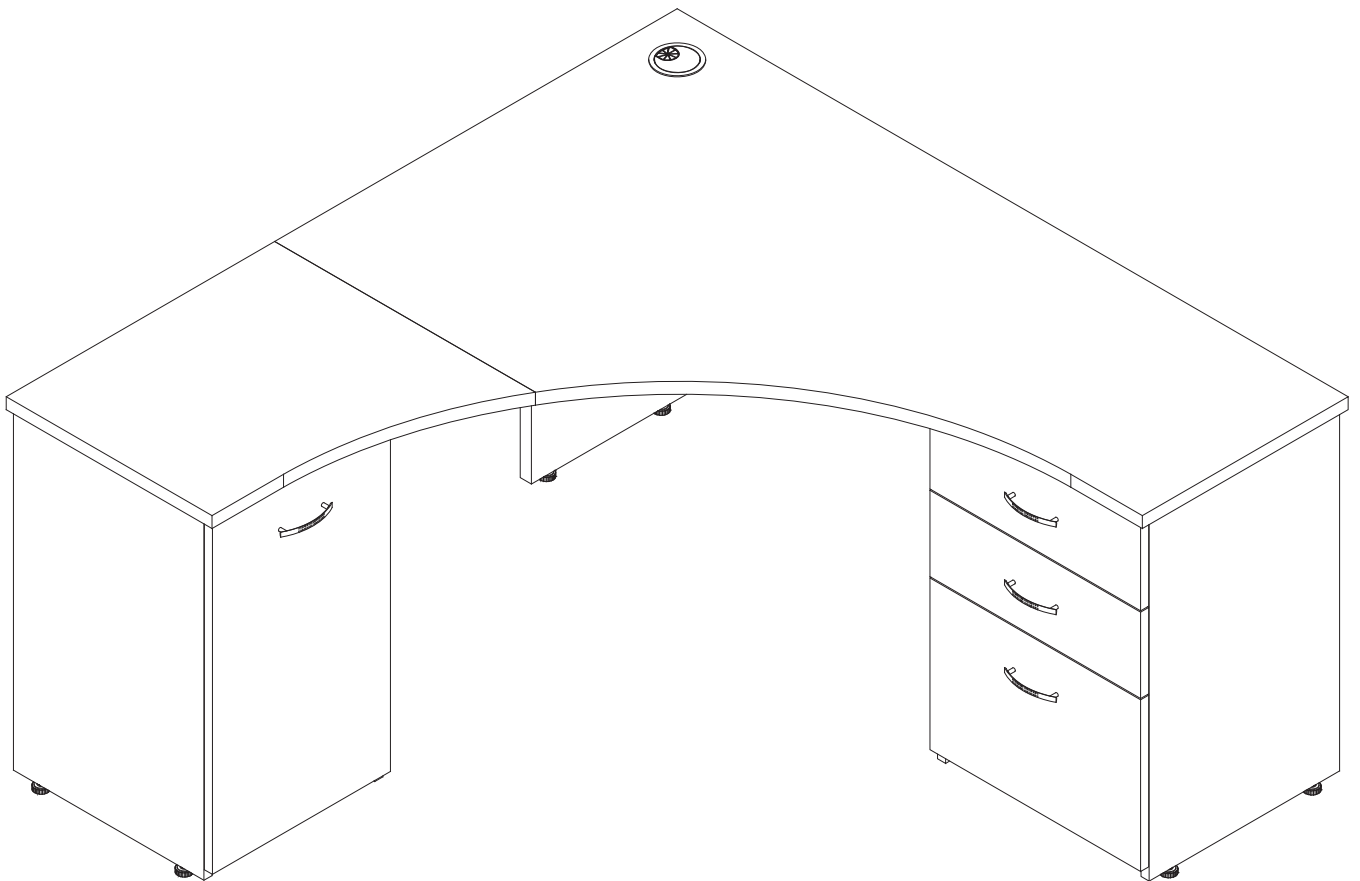

**Your MERGE CNR WORKSTATION (3CTNS)
is now complete and ready for use.**

hinge adjustment

If the doors do not appear square or aligned, loosen or tighten the appropriate screws on each case hinge as illustrated.

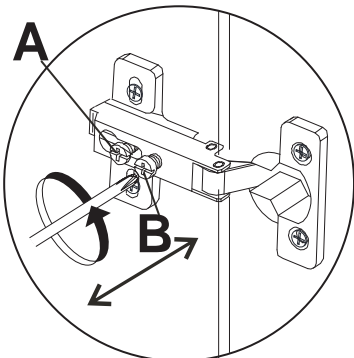

1) **Side to side adjustment:**
Loosen screw **A**, adjust gap with screw **B** and re-tighten screw **A**.

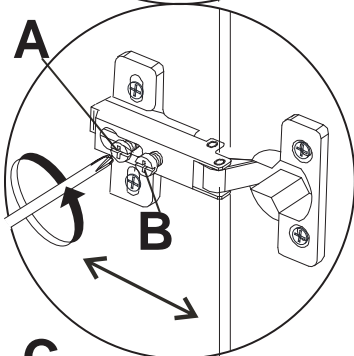

2) **Depth adjustment:**
Loosen screw **A**, push hinge arm forwards or backwards, re-tighten screw **A** and secure screw **B** with a 1/4 turn clockwise.

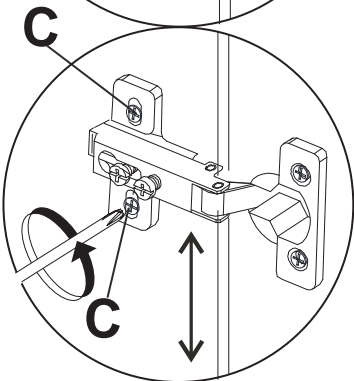

2) **Height adjustment:**
Loosen screw **C**, adjust door height and re-tighten screw **C**.